

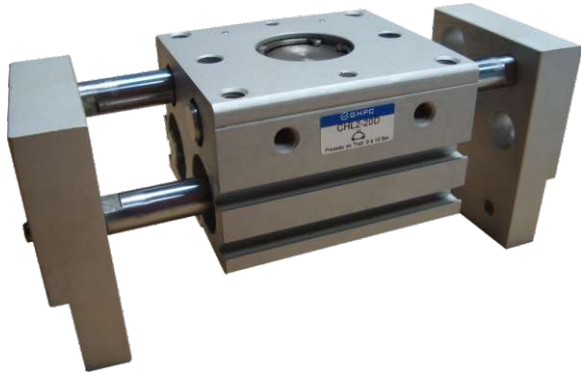

Garra paralela guiada de 2 dedos - Série CHL2



CHL2 -
 Modelo

D
 Dupla Ação Magnético

Diâmetro	
10	10mm
16	16mm
20	20mm
25	25mm
32	32mm
40	40mm

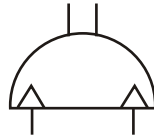

Exemplo: **CHL2-16D**
CHL2-32D

Características Técnicas						
Diâmetro (mm)	10	16	20	25	32	40
Fluído	Ar					
Funcionamento	Dupla Ação					
Pressão de trabalho (Bar)	1.5 à 6	1 à 6				
Temp. de trabalho (°C)	-10 à 60					
Repetitividade	±0.1					
Lubrificação	Não é necessário					
Força de retenção efetiva (N) à 5 Bar ¹	14	45	74	131	228	396

Nota ¹) Ponto de retenção: Diâmetro: 10, 16, 20, 25 = 40mm
 Diâmetro: 32, 40 = 80mm

Modelo	Diâmetro (mm)	Frequência Máx. de Funcionamento (c.p.m)	Curso de abertura / fechamento (L ₂ - L ₁) (mm)	Distância entre dedos (mm) Fechada (L ₁)	Distância entre dedos (mm) Aberta (L ₂)	Peso (g)
CHL2-10D	10	60	20	56	76	280
CHL2-16D	16	60	30	68	98	585
CHL2-20D	20	60	40	82	122	1025
CHL2-25D	25	60	50	100	150	1690
CHL2-32D	32	30	70	150	220	2905
CHL2-40D	40	30	100	188	288	5270

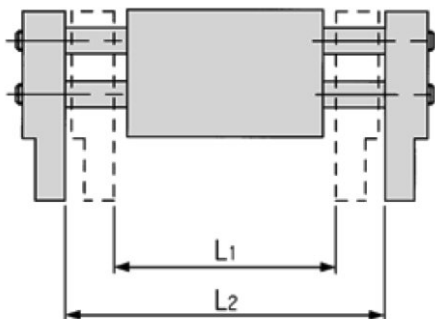

Nota: Os intervalos de tempo de abertura e fechamento representam o valor quando o exterior da peça está a ser retido.

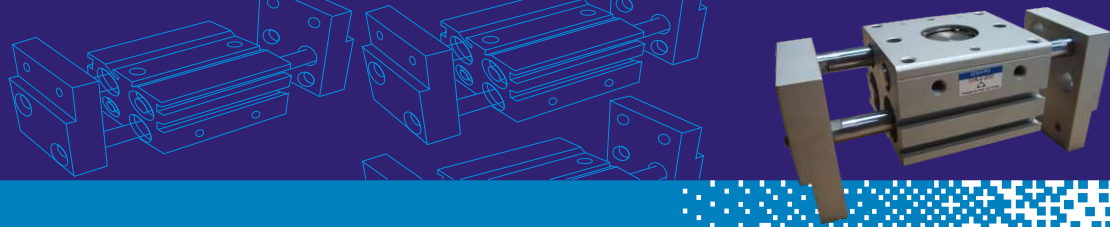

Sensores Aplicáveis

SM - 32



Tipo	Cabo
R - Reed (2 fios)	M8 - Conector M8
P - PNP (3 fios)	2M - 2 metros
N - NPN (3 fios)	

Exemplo: SM-32P-M8
SM-32R-2M

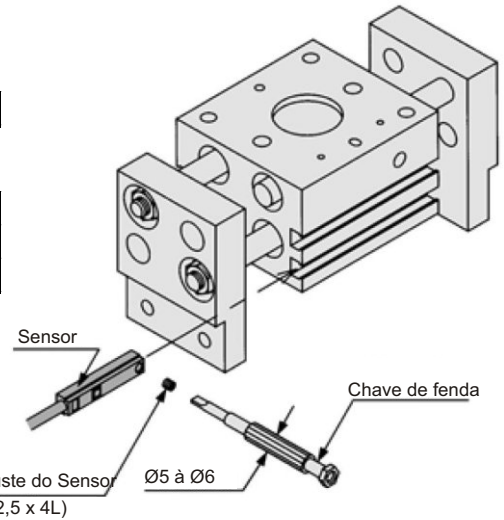

Kit de Reparo		
Ø da Garra	Código	Compõe o kit
10	KR-CHL210	Vedações do êmbolo; Vedações das hastes.
16	KR-CHL216	
20	KR-CHL220	
25	KR-CHL225	
32	KR-CHL232	
40	KR-CHL240	

Distância ao ponto de retenção

Certifique-se de que a distância do ponto de aperto da carga se situa dentro da margem das curvas de força de aperto indicadas por cada pressão no gráfico de força de aperto efetiva.

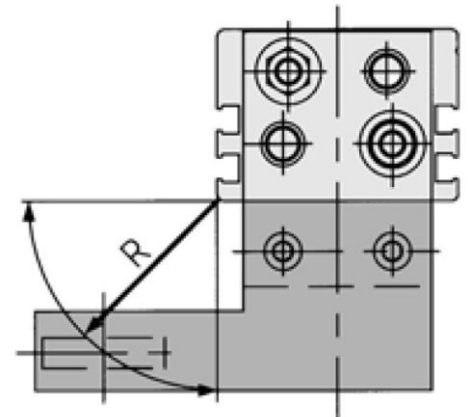

R: Posição de retenção (mm)

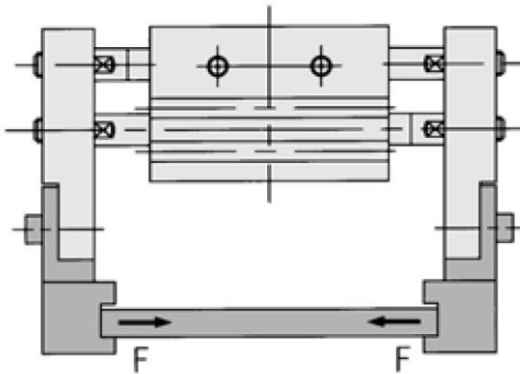

Força de retenção efetiva

Indicação da força de retenção efetiva
A força de retenção indicada nas tabelas representa a força de retenção de um dedo quando todos os dedos e garras estão em contato com a carga. F = impulso de um dedo.

CHL2-10D

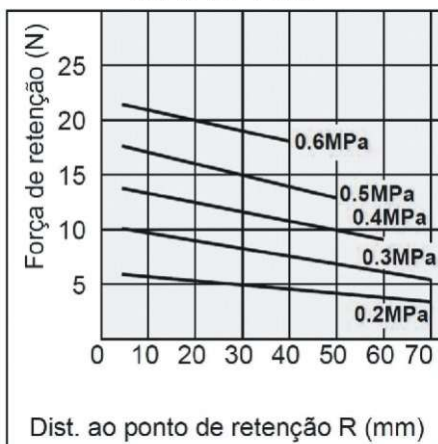

CHL2-16D

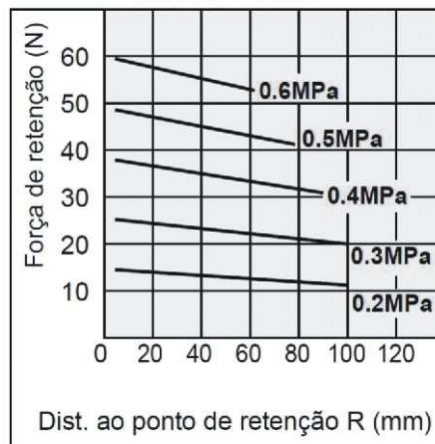

CHL2-20D

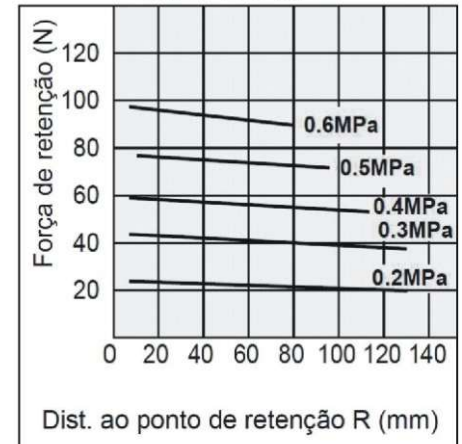

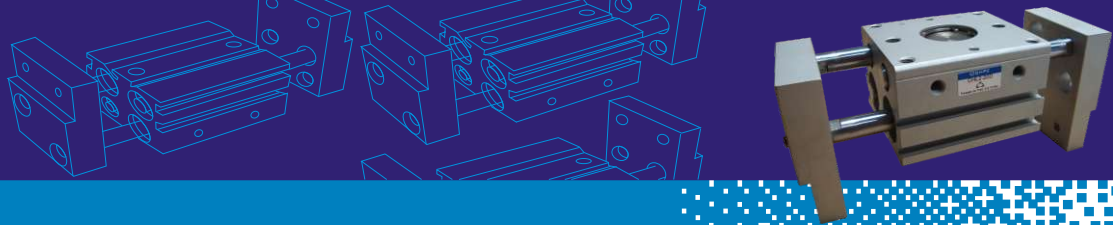

Dimensionais

CHL2-25D

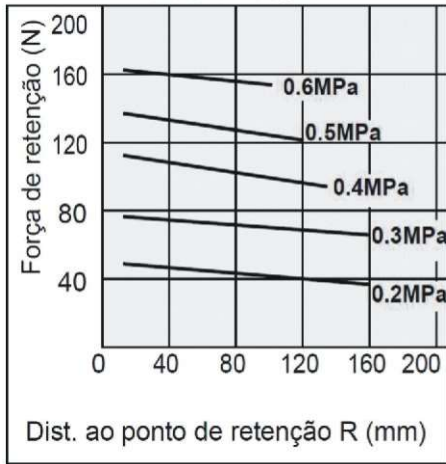

CHL2-32D

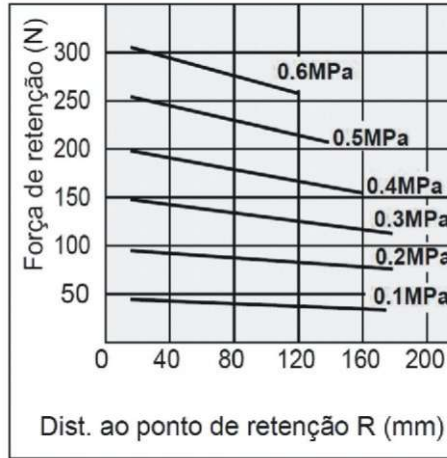

CHL2-40D

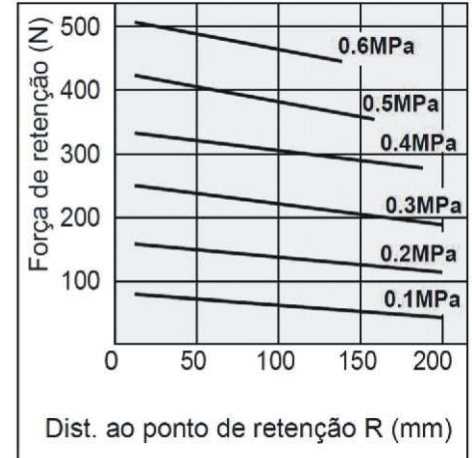

Obs: 0.1 MPa = 1 Bar = 14.5 PSI

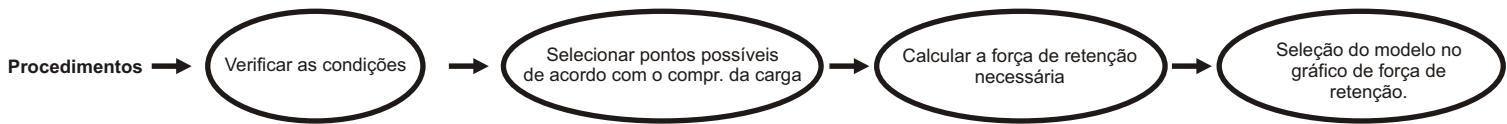

Peso da carga: 0.3 Kg

Formato da carga

Diâmetro: 200mm
Comprimento: 20mm

Abertura: 28 ou mais
Selecione um modelo que possa criar uma força de retenção de 10 a 20 vezes maior que o peso da carga.

Para definir a força de retenção como pelo menos 20 vezes maior que o peso da carga:

$$\text{Força necessária} = 0.3\text{kg} \times 9.8\text{m/s}^2 = 58.8\text{N}$$

CHL2-20D

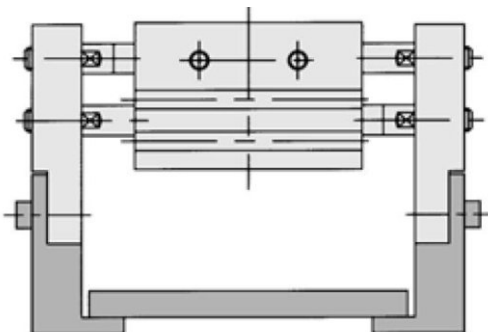
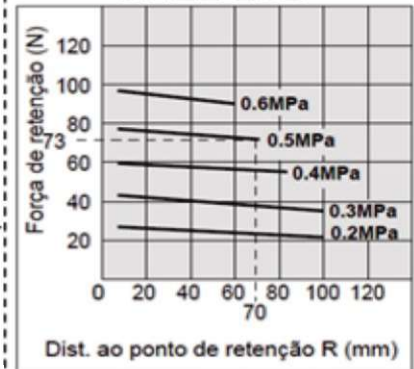

Nota: Se não for totalmente necessário posicionar a carga e se a garra pneumática for utilizada para prender apenas a carga nos dedos, é possível deslocar uma carga que tenha um peso proporcional à força de aperto.

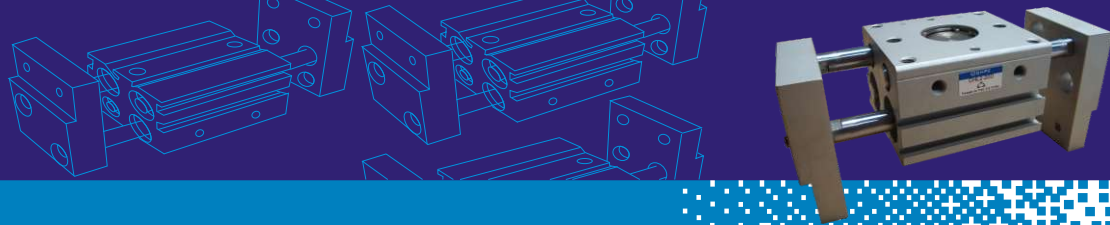

Dimensionais - Ø16mm

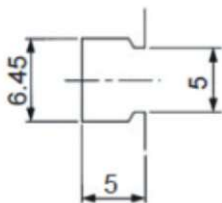
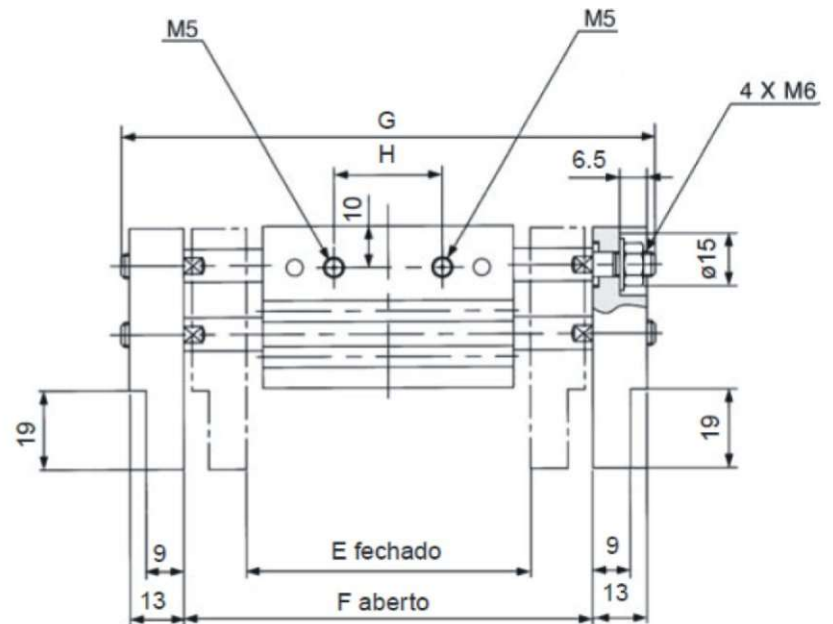
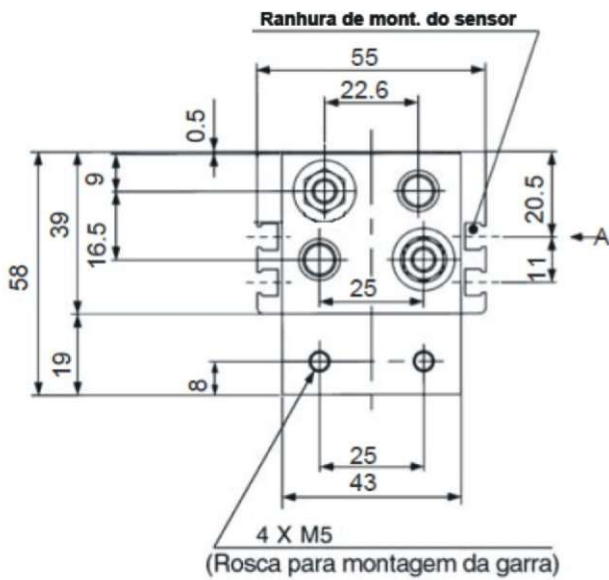

* Dimensões da ranhura de montagem do sensor (Ampliação)

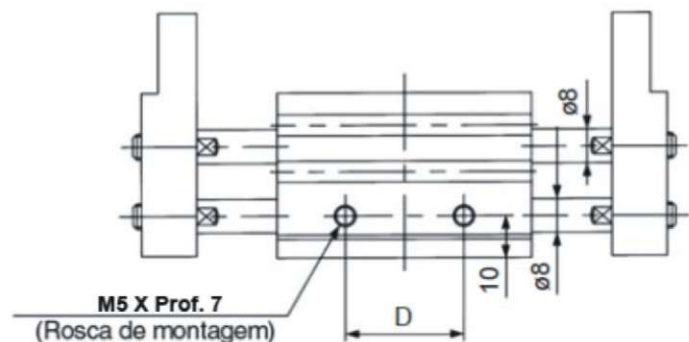
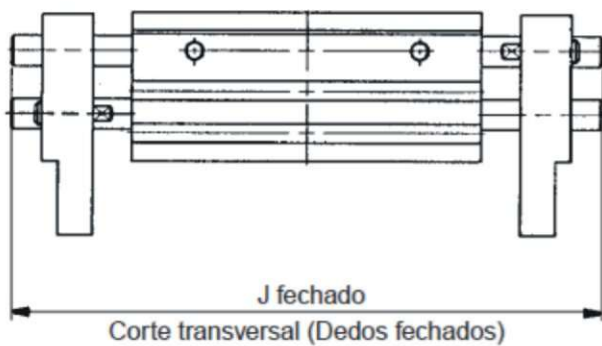
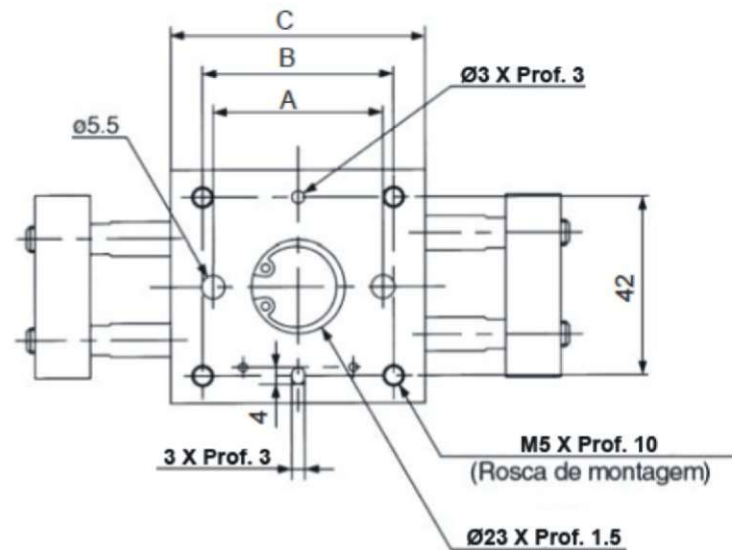

Modelo	A	B	C	D	E	F	G	H	J
CHL2-16D	40	45	60	28	68	98	128	26	98

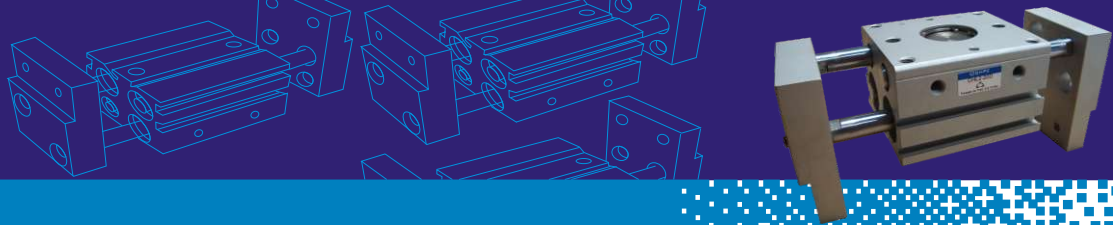

Dimensionais - Ø20mm

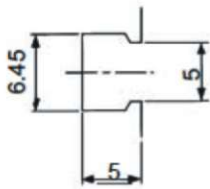
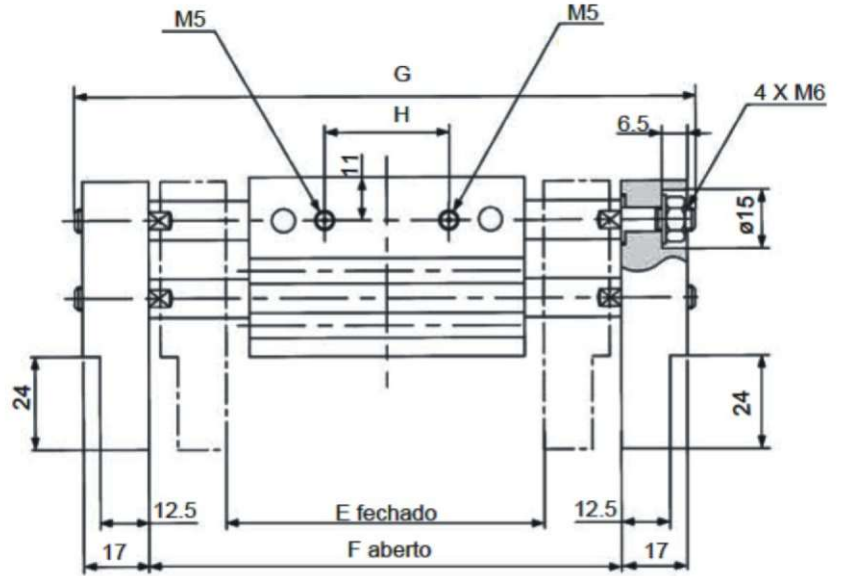
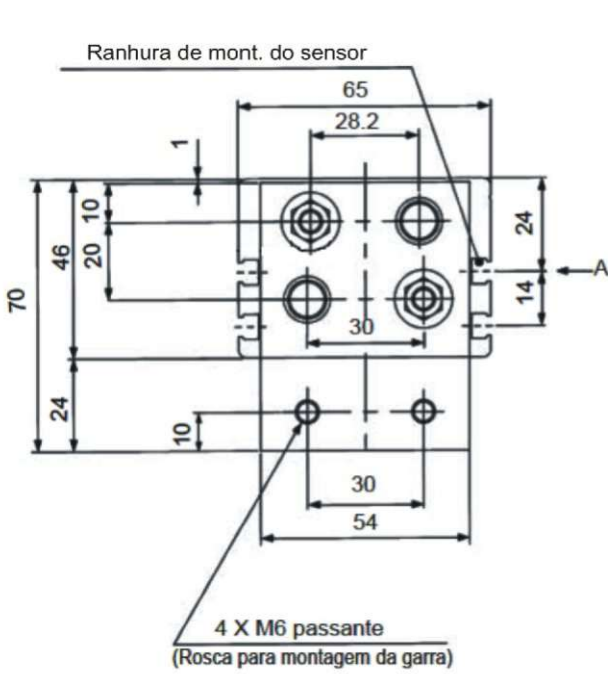

* Dimensões da ranhura de montagem do sensor (Ampliação)

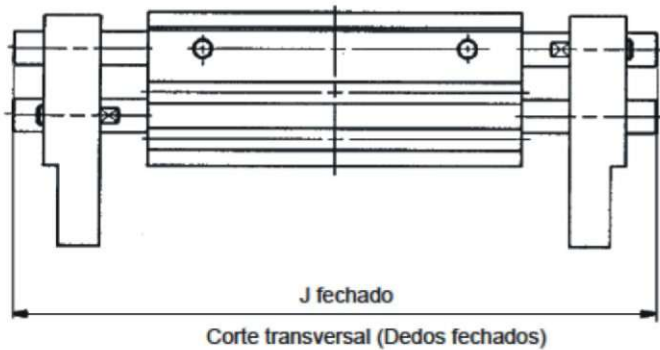
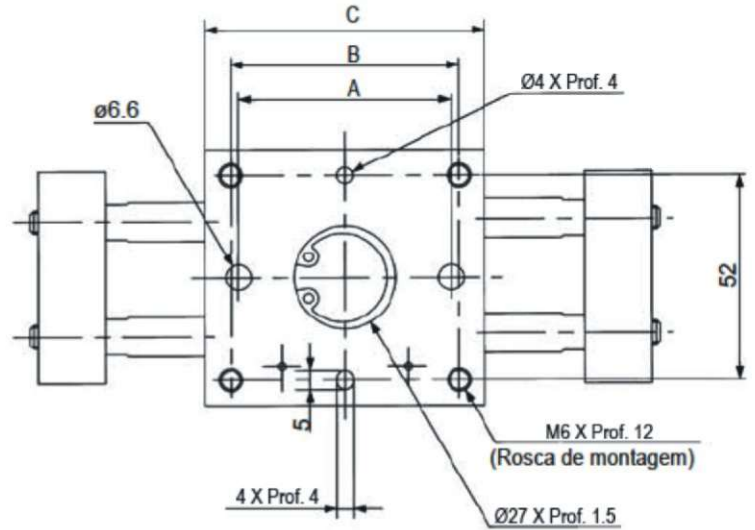

Corte transversal (Dedos fechados)

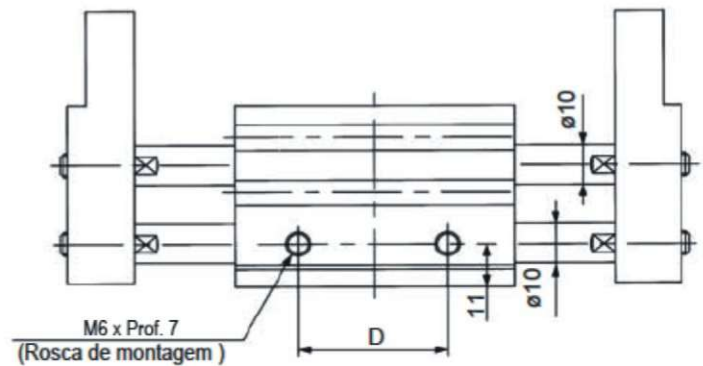

Modelo	A	B	C	D	E	F	G	H	J
CHL2-20D	54	58	71	38	82	122	160	32	120

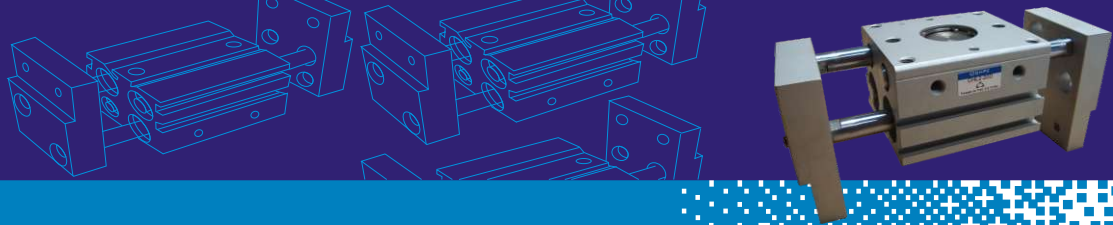

Dimensionais - Ø25mm

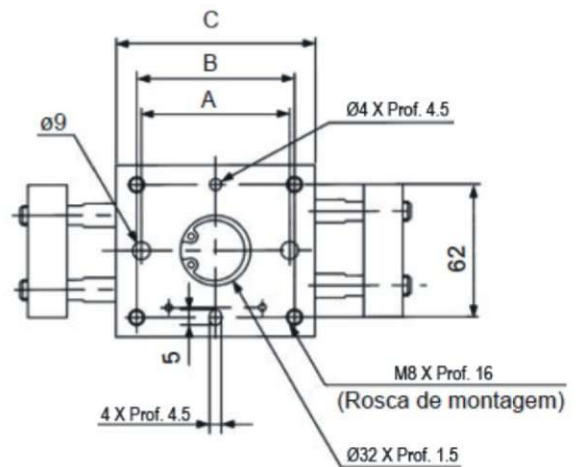
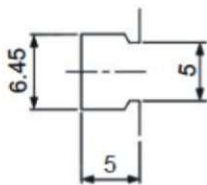
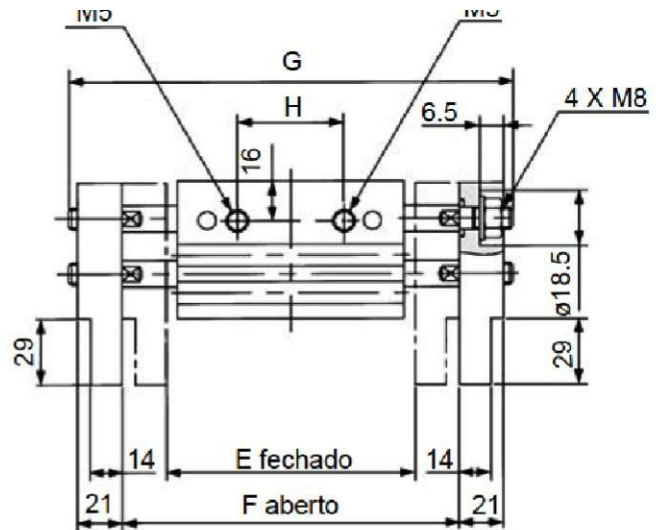
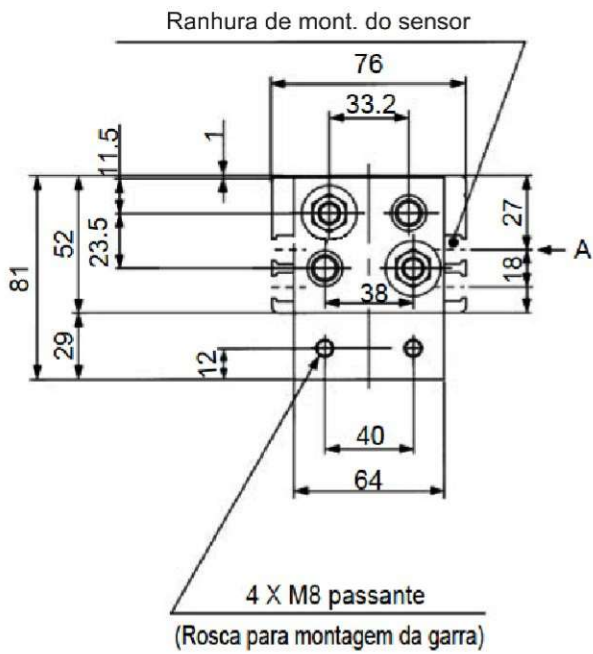

* Dimensões da ranhura de montagem do sensor (Ampliação)

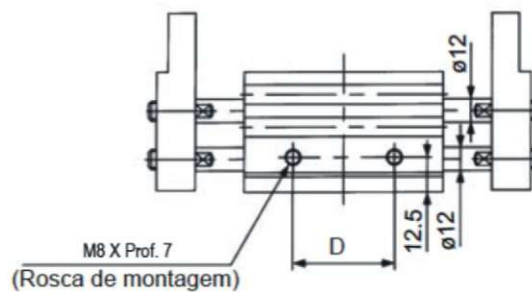
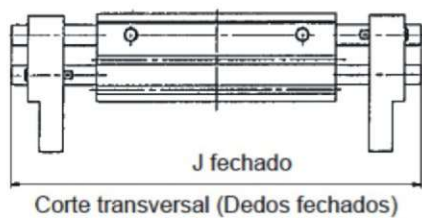

Modelo	A	B	C	D	E	F	G	H	J
CHL2-25D	66	70	88	48	100	150	196	38	146

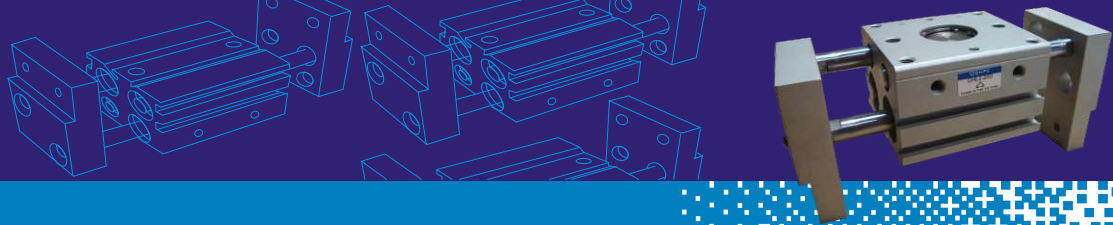

Dimensionais - Ø32mm

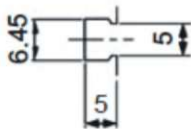
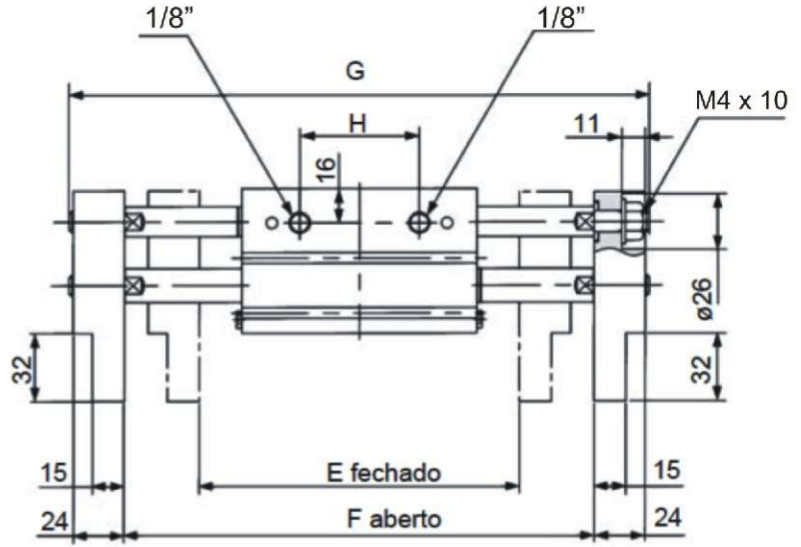
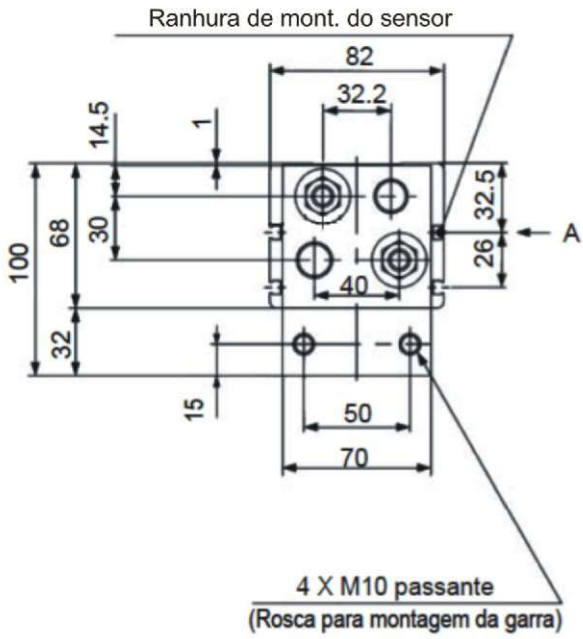

* Dimensões da ranhura de montagem do sensor (Ampliação)

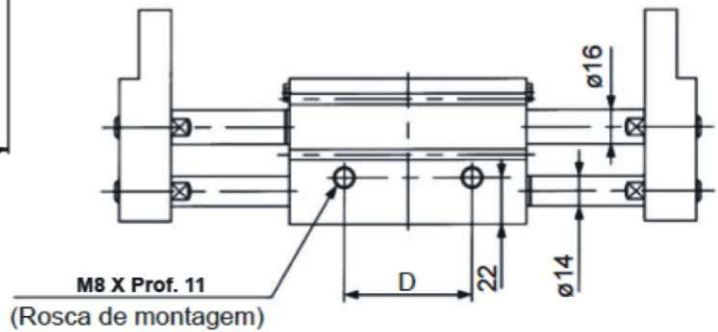
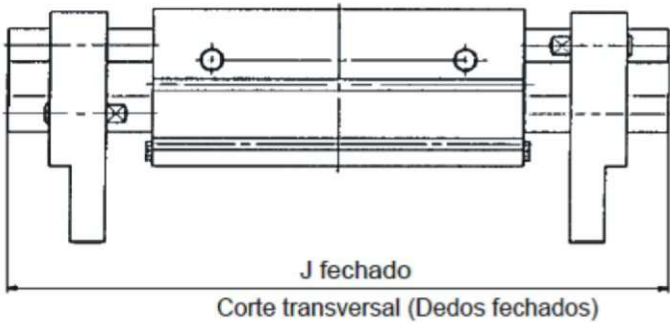
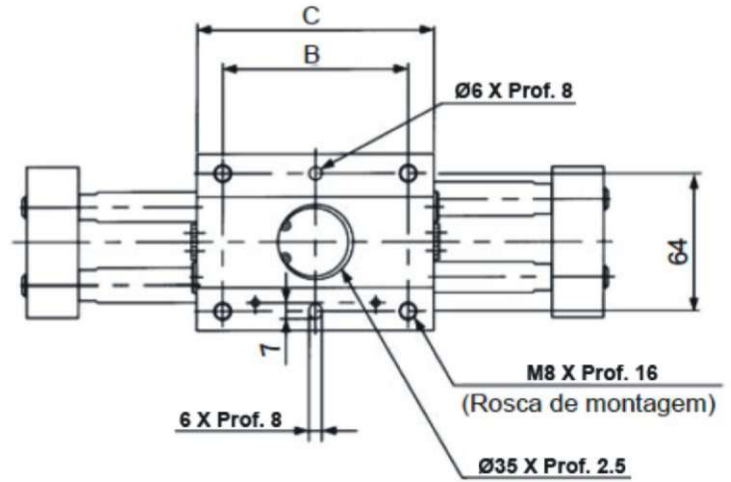

Modelo	B	C	D	E	F	G	H	J
CHL2-32D	86	110	60	150	220	272	56	202

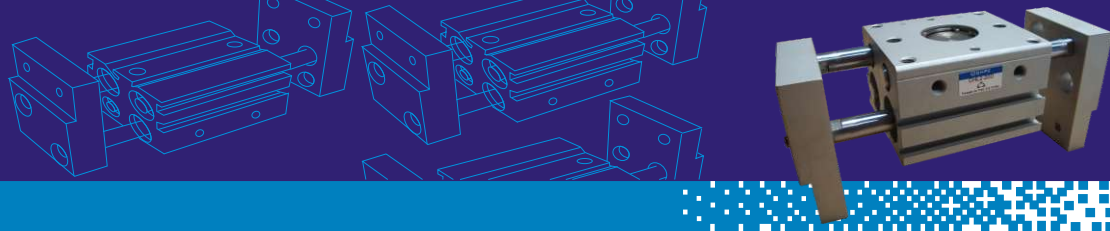

Dimensionais - Ø40mm

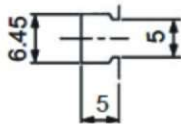
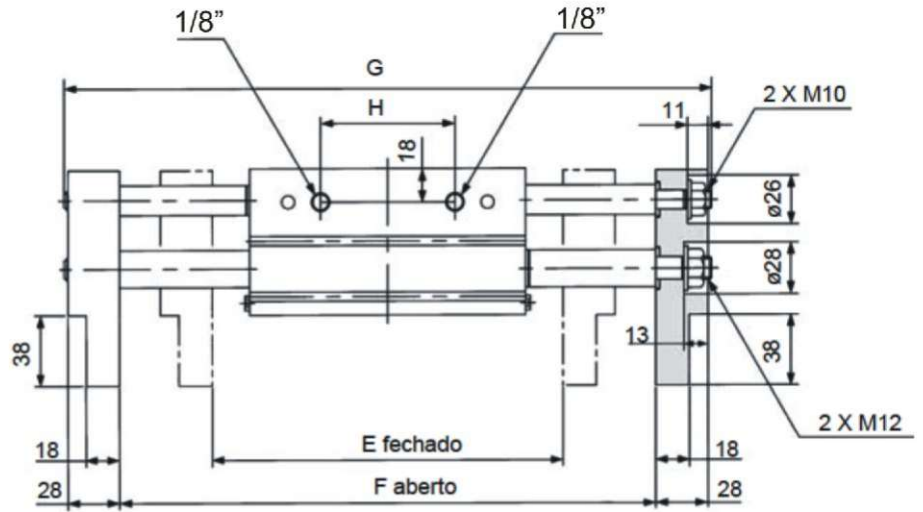
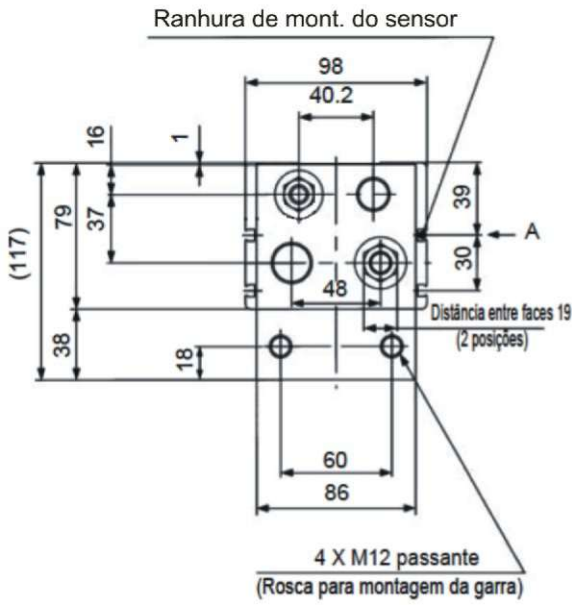

* Dimensões da ranhura de montagem do sensor (Ampliação)

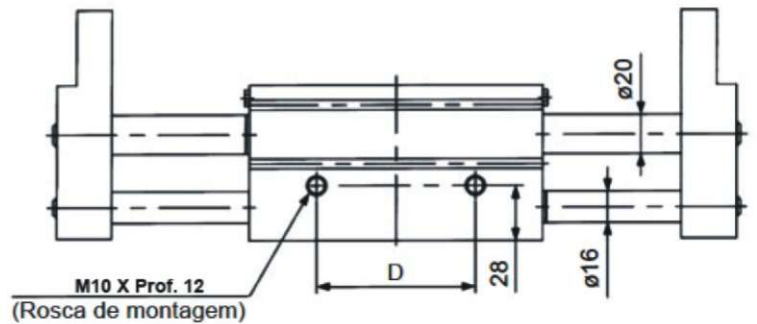
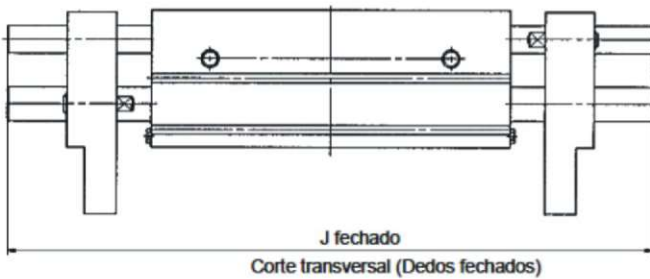
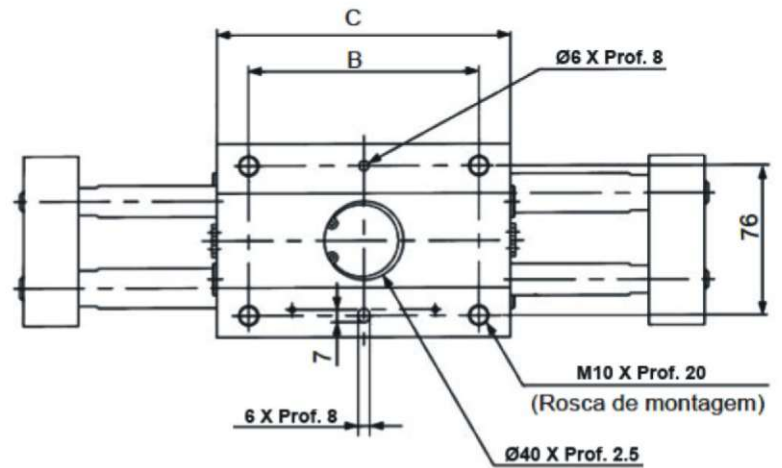

Modelo	B	C	D	E	F	G	H	J
CHL2-40D	116	148	80	188	288	348	72	252